

## Instructions



# Flowerpot VP1

## By Verner Pantón

### 1968

---

Congratulations on choosing this original Flowerpot lamp, designed in 1968 by Verner Pantón. We hope you will enjoy using this lamp and follow these instructions to ensure correct installation. If you have any questions or comments, please do not hesitate to contact us by mail on:

[info@andtradition.com](mailto:info@andtradition.com)

# Flowerpot VP1

## By Verner Pantón

### 1968

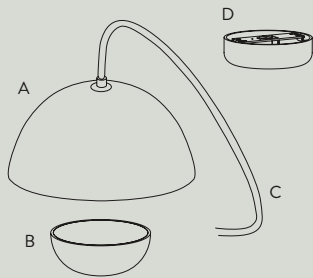

Please read these instructions carefully and retain them for future reference to ensure that the product is used correctly. For your own safety, please study each step of this instruction manual first. &Tradition is not responsible for any faults or damages caused by not following these instructions correctly. Do not modify this product in any way.

#### Contents

- A Shade
- B Bottom Shade
- C 3 meter fabric cord
- D Canopy with metal ceiling bracket

#### Tools needed

- Small flat-head screwdriver for wiring
- Cable cutters
- Cable stripper
- Bulb type E27

#### Safety precautions

- Dispose of plastic bag from packaging and do not allow children to play with it.
- Keep product well out of children's reach.
- The lamp is only intended for interior use.
- Lamp exterior gets hot after prolonged use.
- Do not attempt installation of product if you are not competent to do so yourself.
- Consult a professionally qualified electrician if in any doubt.
- Disconnect the electricity supply at the fuse box, before commencing work.

#### Cleaning instructions

- Wipe surface of lamp shade with a soft, damp sponge or cloth.
- Do not use any abrasive cleaning tools such as steel wool, scouring sponges or stiff brushes.
- Never use strong cleaning agents such as white spirit, turpentine, household glass cleaner or cellulose thinners.
- Only wipe the inside of the shade with a soft, damp cloth or feather duster.



Maximum 40 W. E27 | Not included

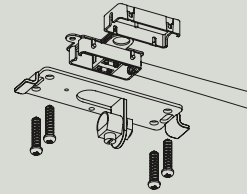

#### Step 1

Ensure power supply is turned OFF and remove any existing lamp fitting. Locate the supply cable and ensure it is ready to be fitted to the connector block. Mount the metal bracket securely in the ceiling with screws and wall plugs, appropriate for the ceiling of installation.

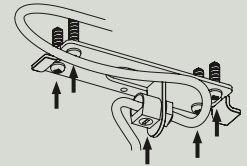

#### Step 2

To determine the right suspension height for the lamp, pass the electrical cord through the strain relief of the metal bracket. When you have the desired suspension height of the lamp, tighten the plastic screw of the strain relief.

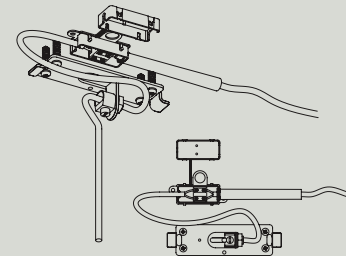

#### Step 3

Connecting the wires:

Cut off the excess cord using a cable cutter so that minimum of 80 mm cord is left to reconnect to the cable connector. Peel back the outer cable using a cable stripper to expose 30 mm of the blue and brown inner cables. Strip the inner cable to expose 5 mm of wire. Connect the blue supply wire to the blue fixture wire. Connect the brown supply wire to the brown fixture wire. Connect the green supply wire to the green fixture wire.

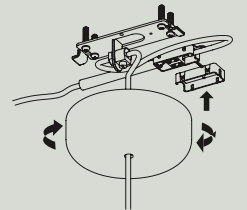

#### Step 4

Install the plastic canopy onto the metal plate.

#### Step 5

Install the lightbulb.

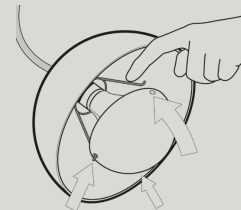

#### Step 6

Mount the shade onto the three pronged arm inside the shade as shown in the diagram. Switch on the power supply at the fusebox and enjoy your new lamp.

220-240V - 50 Hz



&Tradition®